

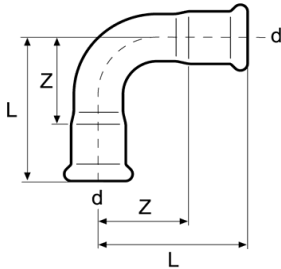

Curva 90°

Bend 90°

Bogen 90°





Code	d	Radius	L	Z		MOQ
G20ZC	15	1,2	42	21	51	100
G20ZD	18	1,2	45	24	62	100
G20ZE	22	1,2	53	30	88	100
G20ZF	28	1,2	61	37	125	60
G20ZG	35	1,2	72	45	180	60
G20ZH	42	1,2	87	55	262	30
G20ZJ	54	1,2	107	70	405	20
G20ZK	76,1	1,2	154	99	1.180	5
G20ZL	88,9	1,2	174	111	1.490	5
G20ZM	108	1,2	215	138	1.948	5
<hr/>						
G20AC	15	1,5	48	27	56	100
G20AD	18	1,5	53	32	70	100
G20AE	22	1,5	61	38	100	100
G20AF	28	1,5	72	48	144	60
G20AG	35	1,5	87	60	206	60
G20AH	42	1,5	115	83	330	30
G20AJ	54	1,5	142	105	503	20

Curva 90° MF

Bend 90° with plain end

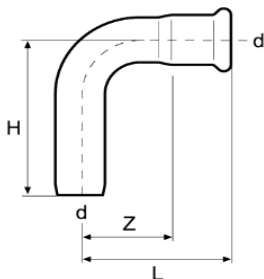
Einsteckbogen 90°



Code	d	Radius	L	H	Z		MOQ
G21ZC	15	1,2	42	52	21	50	100
G21ZD	18	1,2	45	53	24	61	100
G21ZE	22	1,2	53	63	30	88	100
G21ZF	28	1,2	61	71	37	126	50
G21ZG	35	1,2	72	80	45	180	50
G21ZH	42	1,2	87	97	55	258	20
G21ZJ	54	1,2	107	116	70	376	20
G21ZK	76,1	1,2	154	171	99	1.127	5
G21ZL	88,9	1,2	174	191	111	2.222	5
G21ZM	108	1,2	215	234	138	2.220	5
<hr/>							
G21AC	15	1,5	48	57	27	58	100
G21AD	18	1,5	53	62	32	73	100
G21AE	22	1,5	61	70	38	102	100
G21AF	28	1,5	72	80	48	147	50
G21AG	35	1,5	87	94	60	206	50
G21AH	42	1,5	115	125	83	331	20
G21AJ	54	1,5	142	150	105	513	20