

Bemaßung Tempergussfittings

Stand 04.03.15

DN 50 x 32 (2"x11/4")	35		II	16
DN 50 x 40 (2"x11/2")	35		II	16
DN 65 x 25 (21/2"x1")	40	54	III	37
DN 65 x 32 (21/2"x11/4")	40	54	III	35
DN 65 x 40 (21/2"x11/2")	40		II	21
DN 65 x 50 (21/2"x2")	40		II	16
DN 80 x 20 (3"x3/4")				
DN 80 x 25 (3"x1")	44	59	III	42
DN 80 x 32 (3"x11/4")	44	59	III	40
DN 80 x 40 (3"x11/2")	44	59	III	40
DN 80 x 50 (3"x2")	44		II	20
DN 80 x 65 (3"x21/2")	44		II	17
DN 100 x 40 (4"x11/2")				
DN 100 x 50 (4"x2")	51	69	III	45
DN 100 x 65 (4"x21/2")	51	69	III	42
DN 100 x 80 (4"x3")	51		II	21

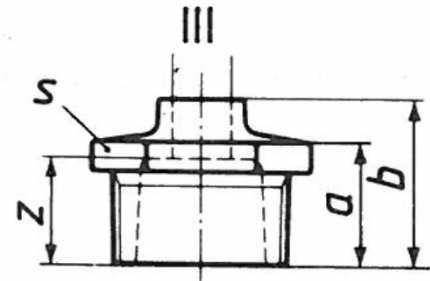

245 – ISO/EN N8

a

DN 8 x 6 (1/4"x1/8")	
DN 10 x 6 (3/8"x1/8")	
DN 10 x 8 (3/8"x1/4")	
DN 15 x 8 (1/2"x1/4")	44
DN 15 x 10 (1/2"x3/8")	44
DN 20 x 10 (3/4"x3/8")	47
DN 20 x 15 (3/4"x1/2")	47
DN 25 x 10 (1"x3/8")	
DN 25 x 15 (1"x1/2")	53
DN 25 x 20 (1"x3/4")	53
DN 32 x 20 (11/4"x3/4")	57
DN 32 x 25 (11/4"x1")	57
DN 40 x 15 (11/2"x1/2")	
DN 40 x 20 (11/2"x3/4")	59
DN 40 x 25 (11/2"x1")	59
DN 40 x 32 (11/2"x11/4")	59
DN 50 x 25 (2"x1")	68
DN 50 x 32 (2"x11/4")	68
DN 50 x 40 (2"x11/2")	68
DN 65 x 50 (21/2"x2")	75
DN 80 x 50 (3"x2")	83
DN 80 x 65 (3"x21/2")	83

