

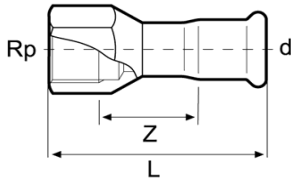

Manicotto misto - filetto femmina

Adaptor with female thread

Übergangsmuffe I.G.



Code	d - Rp	L	Z	 g	MOQ
S80NB-LBP	12-Rp ³ / ₈	49	21	52	100
S80PB-LBP	12-Rp ¹ / ₂	52	24	54	100
S80PC-LBP	15-Rp ¹ / ₂	54	21	60	100
S80QC-LBP	15-Rp ³ / ₄	67	33	91	60
S80PD-LBP	18-Rp ¹ / ₂	52	19	60	100
S80QD-LBP	18-Rp ³ / ₄	58	24	88	100
S80PE-LBP	22-Rp ¹ / ₂	52	17	84	100
S80QE-LBP	22-Rp ³ / ₄	57	21	88	100
S80RE-LBP	22-Rp1	70	31	122	80
S80QF-LBP	28-Rp ³ / ₄	73	36	112	80
S80RF-LBP	28-Rp1	63	23	123	80
S80SF-LBP	28-Rp1 ¹ / ₄	81	40	205	50
S80RG-LBP	35-Rp1	82	39	150	50
S80SG-LBP	35-Rp1 ¹ / ₄	72	28	203	50
S80TG-LBP	35-Rp1 ¹ / ₂	83	39	294	50
S80SH-LBP	42-Rp1 ¹ / ₄	95	46	251	20
S80TH-LBP	42-Rp1 ¹ / ₂	75	26	296	30
S80TJ-LBP	54-Rp1 ¹ / ₂	105	51	373	20
S80VJ-LBP	54-Rp2	85	26	400	20



Codolo - filetto maschio

Adaptor with male thread and plain end

Absatzmuffe A.G.

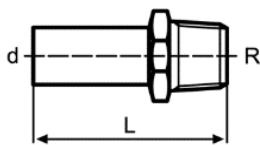

Code	d - R	L	 g	MOQ
S87PC	15-R ¹ / ₂	70	60	100
S87PD	18-R ¹ / ₂	70	63	100
S87QE	22-R ³ / ₄	75	78	100
S87RF	28-R1	75	124	80
S87SG	35-R1 ¹ / ₄	80	195	80
S87TH	42-R1 ¹ / ₂	91	233	50
S87VJ	54-R2	102	419	50



Codolo - filetto femmina

Adaptor with female thread and plain end

Absatzmuffe I.G.

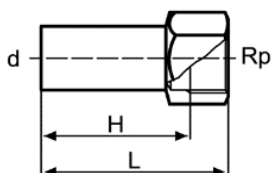

Code	d - Rp	H	L	 g	MOQ
S86PC	15-Rp ¹ / ₂	133	148	83	100
S86PD	18-Rp ¹ / ₂	133	148	90	100
S86QD	18-Rp ³ / ₄	131	148	115	100
S86PE	22-Rp ¹ / ₂	137	152	135	100
S86QE	22-Rp ³ / ₄	136	152	137	100
S86RF	28-Rp1	91	110	147	80
S86SG	35-Rp1 ¹ / ₄	89	110	242	80
S86TH	42-Rp1 ¹ / ₂	90	110	335	50
S86VJ	54-Rp2	94	120	453	50