

Adattatore tee - filetto maschio

T-piece with male thread

T-Stück mit A.G. Abgang

Code	d - R - d	L	L1	Z	I		MOQ
S43PC-LBP	15-R ¹ / ₂ -15	73	36	15	36	90	100
S43NC-LBP	15-R ³ / ₄ -15	73	34	16	36	82	100
S43PD-LBP	18-R ¹ / ₂ -18	77	38	17	38	94	100
S43QD-LBP	18-R ³ / ₄ -18	77	40	17	38	110	100
S43QE-LBP	22-R ³ / ₄ -22	83	42	18	41	130	100
S43RF-LBP	28-R1-28	92	49	22	46	201	80
S43SG-LBP	35-R ¹ / ₄ -35	101	54	23	50	284	50

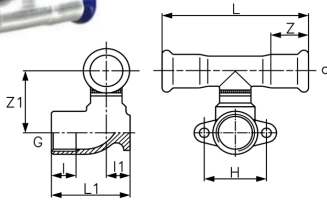

Tee disassato

Misaligned T-piece

Vershoben T-Stück

Code	d - G (ISO 228)	L	L1	Z	Z1	H	I	I1		MOQ
S48PC-LBP	15-G ¹ / ₂	73	43	21	30	34	13	13	144	100
S48PD-LBP	18-G ¹ / ₂	77	43	21	32	34	13	13	146	100

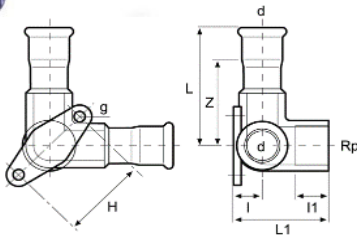

Trivio 90° filetto femmina con flangia

Double tap connector 90°/90° with female thread

Drei-Weg-Übergang mit Einseitig I.G.

Code	d - Rp	L	L1	I	I1	Z	H	g		MOQ
S36PC-LBP	15-Rp ¹ / ₂	57	43	13	15	36	39	5	166	50

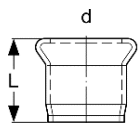

Mezzo manicotto a saldare

Welding joint

Kombimuffe mit Anschweissende

Code	d	L		MOQ
S17AC-LBP	15	26	20	200
S17AD-LBP	18	26	23	200
S17AE-LBP	22	28	30	200
S17AF-LBP	28	31	40	150
S17AG-LBP	35	35	54	150
S17AH-LBP	42	39	75	100
S17AJ-LBP	54	44	106	100
S17AK	76	69	316	50
S17AL	89	80	424	50
S17AM	108	96	621	50

Fornito senza sleeve e con guarnizione a parte.
Per conoscere le condizioni di impiego di questo
componente siete pregati di contattare il nostro
ufficio tecnico.

Supplied without sleeve and with separate gasket.
Correct conditions of use have to be requested
from our technical department.

Lieferung ohne Pressindikator und mit separater
Dichtung. Unsere technische Abteilung gibt
Auskunft für eine korrekte Anwendung.