

Update: 01/2023



ACCIAIO INOX AISI 316L
STAINLESS STEEL AISI 316L
EDELSTAHL AISI 316L



Germany



Switzerland



Norway

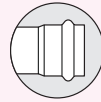

ACCIAIO AL CARBONIO
CARBON STEEL
C-STAHL



Sweden



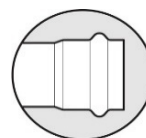

RISE

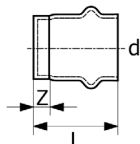

Tappo femmina

Cap

Kappe

Code	d	L	Z			MOQ
C50ABVI-LBP	12	33	15	17	20	100
C50ACVI-LBP	15	38	17	27	20	100
C50ADVI-LBP	18	39	18	32	20	100
C50AEVI-LBP	22	43	20	44	10	100
C50AFVI-LBP	28	46	22	60	10	60
C50AGVI-LBP	35	54	27	84	10	60
C50AHVI-LBP	42	64	32	122	10	40
C50AJVI-LBP	54	71	34	175	10	20

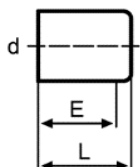

Tappo maschio

Plug

Stopfen

Code	d	L	E			MOQ
C51AB	12	36	30	14	20	60
C51AC	15	42	33	22	20	60
C51AD	18	40	33	28	20	60
C51AE	22	43	34	38	10	60
C51AF	28	47	36	50	10	60
C51AG	35	49	40	70	10	60
C51AH	42	55	44	96	10	40
C51AJ	54	62	49	144	10	20
C51AK	76,1	87	74	380	1	5
C51AL	88,9	92	78	474	1	5
C51AM	108	107	92	698	1	5

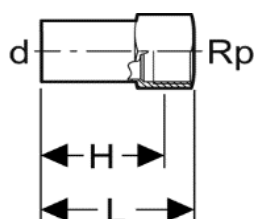

Codolo - filetto femmina

Adaptor with female thread and plain end

Absatzmuffe I.G.

Code	d - Rp	L	H			MOQ
C86NB	12-Rp ^{3/8}	54	44	66	20	60
C86PB	12-Rp ^{1/2}	58	46	60	20	60
C86NC	15-Rp ^{3/8}	74	64	64	20	60
C86PC	15-Rp ^{1/2}	61	49	73	20	60
C86PD	18-Rp ^{1/2}	61	49	71	20	60
C86QD	18-Rp ^{3/4}	64	51	125	20	60
C86PE	22-Rp ^{1/2}	61	49	69	20	60
C86QE	22-Rp ^{3/4}	65	52	124	10	60