

Manicotto passante

Slip Coupling

Schiebemuffe

Code	d	L	E	 g	MOQ
S11AB-LBP	12	56	20	33	100
S11AC-LBP	15	73	24	56	100
S11AD-LBP	18	77	25	63	50
S11AE-LBP	22	83	27	84	50
S11AF-LBP	28	92	28	114	50
S11AG-LBP	35	101	31	153	50
S11AH-LBP	42	118	35	218	30
S11AJ-LBP	54	142	40	327	20
S11AK	76,1	232	60	1011	5
S11AL	88,9	262	70	1.327	5
S11AM	108	312	80	1.928	5

Curva 90°

Bend 90°

Bogen 90°

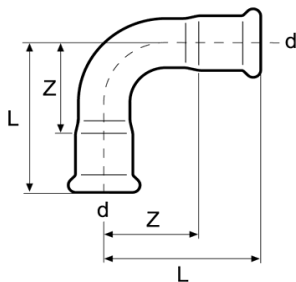

Code	d	Radius	L	Z	 g	MOQ
S20ZB-LBP	12	1,2	42	24	36	100
S20ZC-LBP	15	1,2	42	21	51	100
S20ZD-LBP	18	1,2	45	24	62	100
S20ZE-LBP	22	1,2	53	30	88	100
S20ZF-LBP	28	1,2	61	37	125	60
S20ZG-LBP	35	1,2	72	45	180	60
S20ZH-LBP	42	1,2	87	55	262	30
S20ZJ-LBP	54	1,2	107	70	405	20
S20ZK	76,1	1,2	154	99	1.180	5
S20ZL	88,9	1,2	174	111	1.490	5
S20ZM	108	1,2	215	138	2.222	5
S20AC-LBP	15	1,5	48	27	56	100
S20AD-LBP	18	1,5	53	32	70	100
S20AE-LBP	22	1,5	61	38	100	100
S20AF-LBP	28	1,5	72	48	144	60
S20AG-LBP	35	1,5	87	60	206	60
S20AH-LBP	42	1,5	115	83	330	30
S20AJ-LBP	54	1,5	142	105	503	20